

Technical Specification

- Steel Check Valves, API 602
- Steel Valves, ASME B16.34
- Face to Face, Manufacturer Standard
- Face to Face, Flanged, ASME B16.10
- End Flanges, ASME B16.5
- Buttwelding Ends, ASME B16.25
- Socket-welding Ends, ASME B16.11
- Screwed Ends, ASME B1.20.1
- Inspection and Test, API 598

Design Description

- Bolted Bonnet Cap
- Choice of WB, Welding Bonnet
- Lift or Swing Type
- Seat Rings Integral with Body of Lift
- Horizontal or Vertical Service
- Socket Weld Ends
- SW, Socket-welding Ends
- SC, Screwed Ends
- BW, Buttwelding Ends
- Flanged Ends

Form of Major Part Material

No.	Part Name	ASTM Material							
		Carbon Steel	F11	F22	304 Type	316 Type	304L Type	316L Type	20 Alloy
1	Body	A105	A182 F11	A182 F22	A182 F304	A182 F316	A182 F304L	A182 F316L	20-Alloy
2	Bonnet	A105	A182 F11	A182 F22	A182 F304	A182 F316	A182 F304L	A182 F316L	20-Alloy
3	Disc	A182 F6a	A182 F11+HF	A182 F22+HF	A182 F304	A182 F316	A182 F304L	A182 F316L	20-Alloy
4	Hinge	A182 F6a	A182 F11	A182 F22	A182 F304	A182 F316	A182 F304L	A182 F316L	20-Alloy
5	Seat	A182 F6a	A182 F11+HF	A182 F22+HF	A182 F304	A182 F316	A182 F304L	A182 F316L	20-Alloy
6	Bonnet Gasket	304+Graphit	304+Graphit	304+Graphit	304+Graphit	316+Graphit	304L+Graphit	316L+Graphit	316+Graphit
7	Bonnet Bolt	A193 B7	A193 B7	A193 B16	A193 B8	A193 B8M	A193 B8	A193 B8M	A193 B8M

Class800 Main Outline Dimensions & Weight

Bold valve cover.

Designs according to BS5,352.

R.P			1/2	3/4	1	1 1/4	1 1/2	2	
F.P		1/4	3/8	1/2	3/4	1	1 1/4	1 1/2	2
L	Lift	79	79	92	111	120	152	172	200
	Swing	79	79	92	111	120	120	140	178
H	Lift	61	61	61	78	84	84	118	132
	Swing	61	61	61	78	84	84	120	133
d	Lift	7	9	13	17.5	23	30	35	46
	Swing	8	10.5	13.5	18	24	29	36.5	45
Weight (kg)	Lift	1.2	1.5	1.7	3.3	4.2	4.2	10.5	12.5
	Swing	1.4	1.5	1.7	3.3	4.2	4.2	8.5	10.9

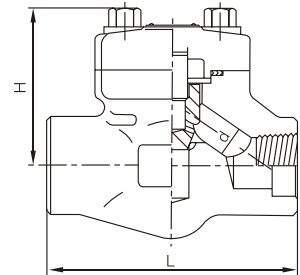

Class800 Main Outline Dimensions & Weight

Weld valve cover.

Designs according to BS5,352.

R.P	-	1/2	3/4	1	1 1/4	1 1/2	2	2 1/2
F.P	1/4	3/8	1/2	3/4	1	1 1/4	1 1/2	2
L	79	79	92	111	120	152	172	200
H	61	61	61	78	84	103	118	132
d	7	9	13	17.5	23	30	35	46
Weight(kg)	1.2	1.3	1.5	3.0	3.9	6.0	10	12

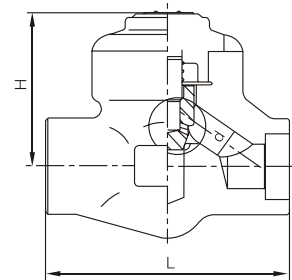

Class900 ~ 1500 Main Outline Dimensions & Weight

Bold valve cover.

Designs according to BS5,352.

R.P			1/2	3/4	1	1 1/4	1 1/2	2	
F.P		1/4	3/8	1/2	3/4	1	1 1/4	1 1/2	2
L	Lift	92	111	111	120	152	172	200	-
	Swing	92	111	111	120	120	140	178	-
H	Lift	61	78	78	84	103	118	132	-
	Swing	61	78	78	84	101	120	133	-
d	Lift	7	12	15	20	28	32	40	-
	Swing	8	10.5	13.5	18.7	24	29	45	-
Weight (kg)	Lift	1.5	3.4	3.3	4.2	6.3	10.5	12.5	-
	Swing	1.5	3.4	3.3	4.2	5.0	8.5	10.9	-

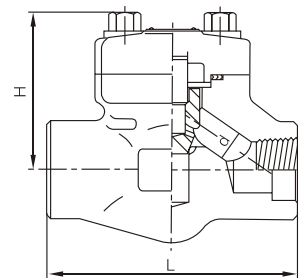

Class900 ~ 1500 Main Outline Dimensions & Weight

Weld valve cover.

Designs according to BS5,352.

R.P	-	1/2	3/4	1	1 1/4	1 1/2	2	2 1/2
F.P	1/4	3/8	1/2	3/4	1	1 1/4	1 1/2	2
L	92	111	111	120	152	172	200	-
H	61	78	78	84	103	118	132	-
d	7	12	15	20	28	32	40	-
Weight(kg)	1.3	3.1	3.1	3.9	5.8	10.0	11.5	-

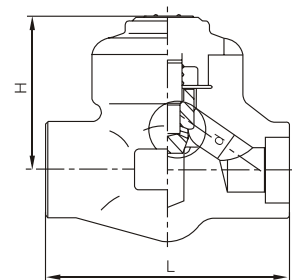

Class900 ~ 1500 Main Outline Dimensions & Weight

Bold valve cover.

Designs according to BS5,352.

F.P		1/4	3/8	1/2	3/4	1	1 1/4	1 1/2	2
L		110	110	110	110	150	150	210	235
H		166	166	171	207	240	258	330	355
d	Lift	9	10	12	15	20	28	32	40
	Swing	8	10.5	13.5	18	24	29	36.5	45
Weight (kg)	Lift	2	2.1	1.9	4	5.1	7.2	12.1	14
	Swing	1.9	2.3	2.3	4.35	5.25	7.8	12.5	14.6

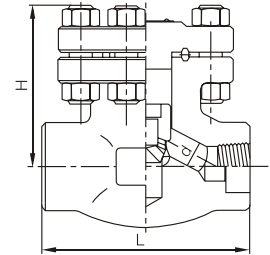

Class900 ~ 1500 Main Outline Dimensions & Weight

Pressure seal bonnet.

Designs according to BS5,352.

R.P		1/2	3/4	1	1 1/4	1 1/2	2
F.P		3/8	1/2	3/4	1	1 1/4	1 1/2
L		140	140	140	178	216	216
H		117	117	117	152	195	195
d		12	15	20	28	28	40
Weight (kg)		7.5	7.0	6.8	18.5	18.5	22

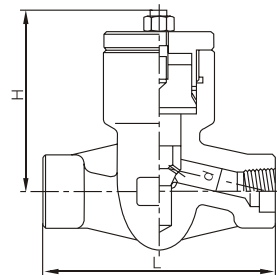

Class2500 Main Outline Dimensions & Weight

Bold valve cover.

Designs according to BS5,352.

F.P		1/4	3/8	1/2	3/4	1	1 1/4	1 1/2	2
L		150	150	150	150	210	235	235	235
H		166	166	171	207	240	258	330	355
d		7.5	10.5	11	14	19	25	28	35
Weight (kg)		1.9	2.3	17	46	62	73	58	85

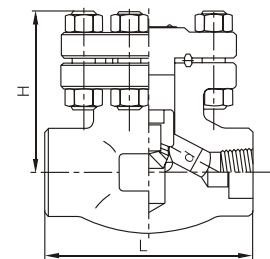

Class2500 Main Outline Dimensions & Weight

Pressure seal bonnet.

Designs according to BS5,352.

F.P		1/2	3/4	1	1 1/4	1 1/2	2
L		186	186	186	232	232	279
H		117	117	117	152	150	195
d		11	14	14	25	28	35
Weight (kg)		11.8	11	11	23	26.4	39

